

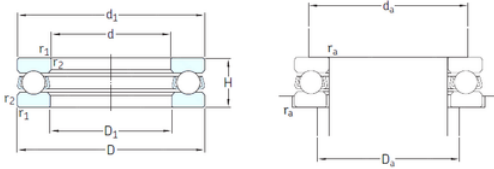

BROWNING BEARING COMPANY



skf 51209 bearing

Bearing No. 51209

Size	45x73x20 mm
Bore Diameter	45 mm
Outer Diameter	73 mm
Width	20 mm
d	45 mm
D	73 mm
H	20 mm
d1	73 mm
r1 min.	1 mm
r2 min.	1 mm
D1	47 mm
da min.	62 mm
Da max.	56 mm
ra max.	1 mm
Weight	0,3 Kg
Basic dynamic load rating (C)	39 kN
Basic static load rating (C0)	86,5 kN
Fatigue load limit (Pu)	3,2
Reference speed	3600 r/min
Limiting speed	5000 r/min
Category	Thrust Ball Bearing
Inventory	0.0
Manufacturer Name	SKF
Minimum Buy Quantity	N/A
Weight / Kilogram	0.314
EAN	7316577058492

51209 Bearing 2D drawings and 3D CAD models



BROWNING BEARING COMPANY

Product Group	B00308
Rolling Element	Ball Bearing
Thrust Bearing	Yes
Single or Double Direction	Single Direction
Banded	No
Cage Material	Steel
Precision Class	ABEC 1 ISO P0
Component Description	Roller Assembly Plus Raceways
Other Features	Single Row
Long Description	45MM Bore 1; 47MM Bore 2; 73MM Outside Diameter; 20MM Height; Ball Bearing; Single Direction; Not Banded; Steel Cage; ABEC 1 ISO P0 Precision
Inch - Metric	Metric
Category	Thrust Ball Bearings
UNSPSC	31171507
Harmonized Tariff Code	8482.10.50.08
Noun	Bearing
Keyword String	Ball Thrust
Manufacturer URL	http://www.skf.com
Manufacturer Item Number	51209
Weight / LBS	0.692
Bore 1	1.772 Inch 45 Millimeter
Overall Height with Aligning Washer	0 Inch 0 Millimeter
Height	0.787 Inch 20 Millimeter
Outside Diameter	2.874 Inch 73 Millimeter
Bore 2	1.85 Inch 47 Millimeter
bore diameter:	45 mm
static load capacity:	86.5 kN
outside diameter:	73 mm



BROWNING BEARING COMPANY

dynamic load capacity:	39 kN
overall width:	20 mm
maximum rpm:	5000 RPM
thrust bearing type:	Single-Direction
cage material:	Steel
outside diameter design:	Straight
fillet radius:	1 mm
separable or banded:	Separable
series:	512
precision rating:	ABEC 1 (ISO Class Normal)
d_1	73 mm
D_1	47 mm
$r_{1,2}$ min.	1 mm
d_a min.	62 mm
D_a max.	56 mm
r_a max.	1 mm
Basic dynamic load rating C	39 kN
Basic static load rating C_0	86.5 kN
Fatigue load limit P_u	3.2 kN
Minimum load factor A	0.038
Mass bearing (including seat washer where applicable)	0.3 kg