

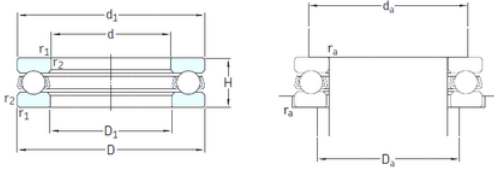

# BROWNING BEARING COMPANY



## skf 51202 bearing

Bearing No. 51202

51202 Bearing 2D drawings and 3D CAD models

Size	15x32x12 mm
Bore Diameter	15 mm
Outer Diameter	32 mm
Width	12 mm
d	15 mm
D	32 mm
H	12 mm
d1	32 mm
r1 min.	0,6 mm
r2 min.	0,6 mm
D1	17 mm
da min.	25 mm
Da max.	22 mm
ra max.	0,6 mm
Weight	0,046 Kg
Basic dynamic load rating (C)	15,9 kN
Basic static load rating (C0)	25 kN
Fatigue load limit (Pu)	0,915
Reference speed	7000 r/min
Limiting speed	10000 r/min
Category	Thrust Ball Bearing
Inventory	0.0
Manufacturer Name	SKF
Minimum Buy Quantity	N/A
Weight / Kilogram	0.049
EAN	7316577058553



## BROWNING BEARING COMPANY

Product Group	B00308
Rolling Element	Ball Bearing
Thrust Bearing	Yes
Single or Double Direction	Single Direction
Banded	No
Cage Material	Steel
Precision Class	ABEC 1   ISO P0
Component Description	Roller Assembly Plus Raceways
Other Features	Single Row
Long Description	15MM Bore 1; 17MM Bore 2; 32MM Outside Diameter; 12MM Height; Ball Bearing; Single Direction; Not Banded; Steel Cage; ABEC 1   ISO P0 Precision
Inch - Metric	Metric
Category	Thrust Ball Bearings
UNSPSC	31171507
Harmonized Tariff Code	8482.10.50.08
Noun	Bearing
Keyword String	Ball Thrust
Manufacturer URL	<a href="http://www.skf.com">http://www.skf.com</a>
Manufacturer Item Number	51202
Weight / LBS	0.107
Bore 1	0.591 Inch   15 Millimeter
Bore 2	0.669 Inch   17 Millimeter
Outside Diameter	1.26 Inch   32 Millimeter
Height	0.472 Inch   12 Millimeter
Overall Height with Aligning Washer	0 Inch   0 Millimeter
bore diameter:	15 mm
static load capacity:	25 kN
outside diameter:	32 mm



## BROWNING BEARING COMPANY

dynamic load capacity:	15.9 kN
overall width:	12 mm
maximum rpm:	10000 RPM
thrust bearing type:	Single-Direction
cage material:	Steel
outside diameter design:	Straight
fillet radius:	0.6 mm
separable or banded:	Separable
series:	512
precision rating:	ABEC 1 (ISO Class Normal)
$d_1$	32 mm
$D_1$	17 mm
$r_{1,2}$ min.	0.6 mm
$d_a$ min.	25 mm
$D_a$ max.	22 mm
$r_a$ max.	0.6 mm
Basic dynamic load rating C	15.9 kN
Basic static load rating $C_0$	25 kN
Fatigue load limit $P_u$	0.915 kN
Minimum load factor A	0.0038
Mass bearing (including seat washer where applicable)	0.046 kg