

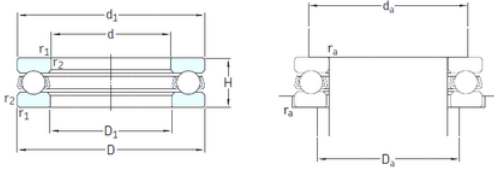

BROWNING BEARING COMPANY



skf 51103 bearing

Bearing No. 51103

51103 Bearing 2D drawings and 3D CAD models

Size	17x30x9 mm
Bore Diameter	17 mm
Outer Diameter	30 mm
Width	9 mm
d	17 mm
D	30 mm
H	9 mm
d1	30 mm
r1 min.	0,3 mm
r2 min.	0,3 mm
D1	18 mm
da min.	25 mm
Da max.	22 mm
ra max.	0,3 mm
Weight	0,025 Kg
Basic dynamic load rating (C)	11,4 kN
Basic static load rating (C0)	21,2 kN
Fatigue load limit (Pu)	0,78
Reference speed	8500 r/min
Limiting speed	12000 r/min
Category	Thrust Ball Bearing
Inventory	0.0
Manufacturer Name	SKF
Minimum Buy Quantity	N/A
Weight / Kilogram	0.03
EAN	7316577058669



BROWNING BEARING COMPANY

Product Group	B00308
Rolling Element	Ball Bearing
Thrust Bearing	Yes
Single or Double Direction	Single Direction
Banded	No
Cage Material	Steel
Precision Class	ABEC 1 ISO P0
Component Description	Roller Assembly Plus Raceways
Other Features	Single Row
Long Description	17MM Bore 1; 18MM Bore 2; 30MM Outside Diameter; 9MM Height; Ball Bearing; Single Direction; Not Banded; Steel Cage; ABEC 1 ISO P0 Precision
Inch - Metric	Metric
Category	Thrust Ball Bearings
UNSPSC	31171507
Harmonized Tariff Code	8482.10.50.08
Noun	Bearing
Keyword String	Ball Thrust
Manufacturer URL	http://www.skf.com
Manufacturer Item Number	51103
Weight / LBS	0.066
Bore 1	0.669 Inch 17 Millimeter
Height	0.354 Inch 9 Millimeter
Overall Height with Aligning Washer	0 Inch 0 Millimeter
Outside Diameter	1.181 Inch 30 Millimeter
Bore 2	0.709 Inch 18 Millimeter
bore diameter:	17 mm
static load capacity:	21.2 kN
outside diameter:	30 mm



BROWNING BEARING COMPANY

dynamic load capacity:	11.4 kN
overall width:	9 mm
maximum rpm:	12000 RPM
thrust bearing type:	Single-Direction
cage material:	Steel
outside diameter design:	Straight
fillet radius:	0.3 mm
separable or banded:	Separable
series:	511
precision rating:	ABEC 1 (ISO Class Normal)
d_1	30 mm
D_1	18 mm
$r_{1,2}$ min.	0.3 mm
d_a min.	25 mm
D_a max.	22 mm
r_a max.	0.3 mm
Basic dynamic load rating C	11.4 kN
Basic static load rating C_0	21.2 kN
Fatigue load limit P_u	0.78 kN
Minimum load factor A	0.0023
Mass bearing (including seat washer where applicable)	0.025 kg